

ROAD

PART 300-075-00

1308.73

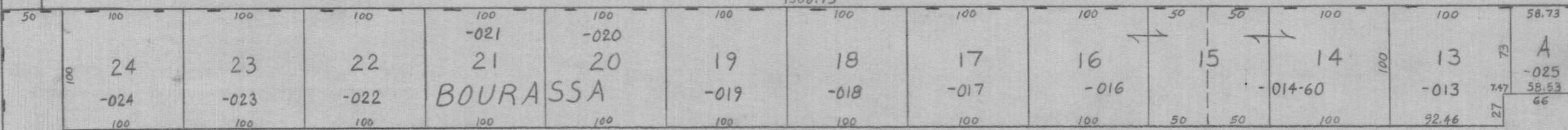

CLARA

(B05)

ST.

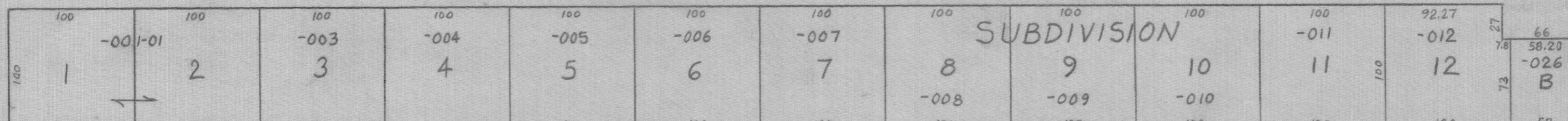

SUBDIVISION

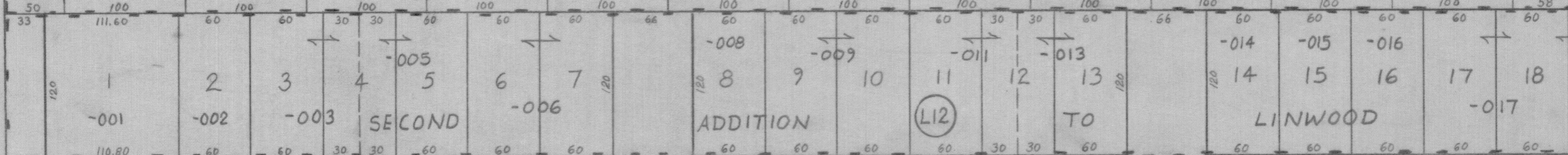

SECOND

ADDITION

(L12)

TO

LINWOOD

EDWIN

ST.

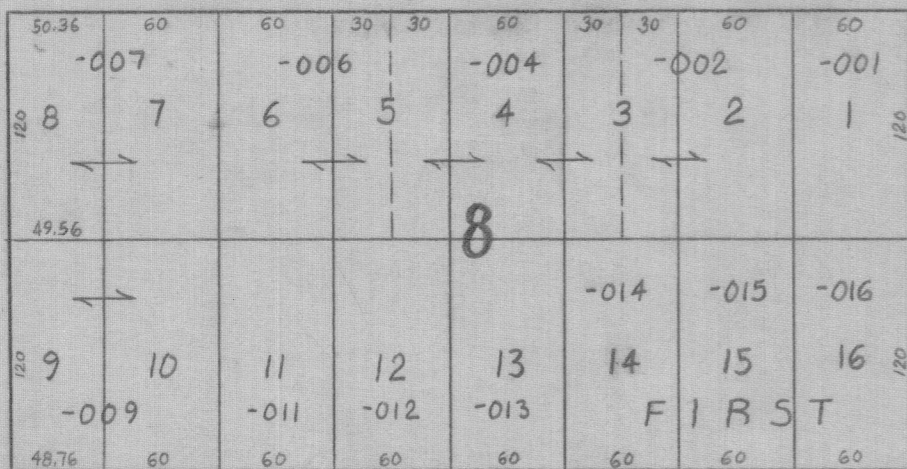

ST.

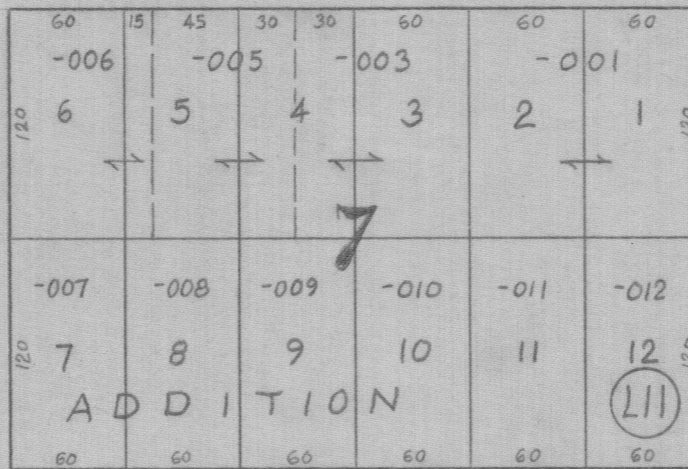

ST.

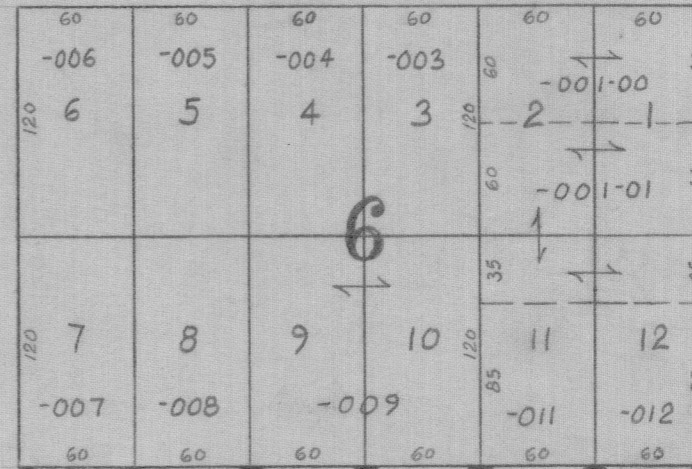

ST.

BENJAMIN

ST.

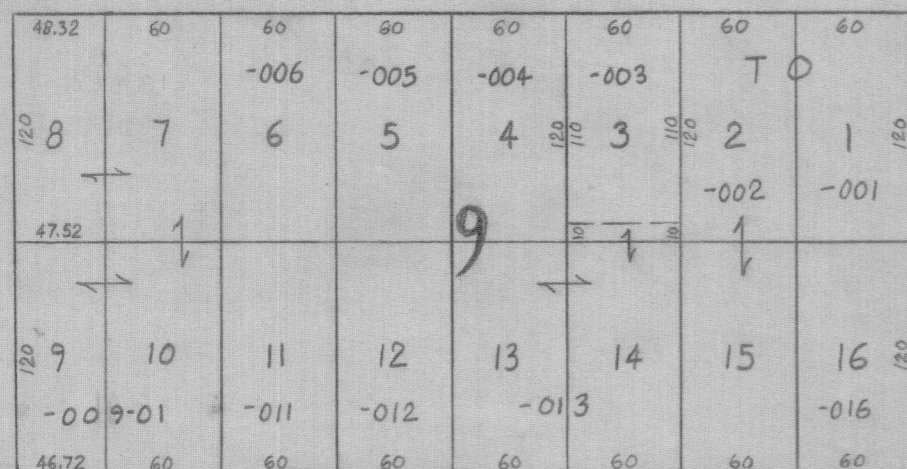

FIFTH

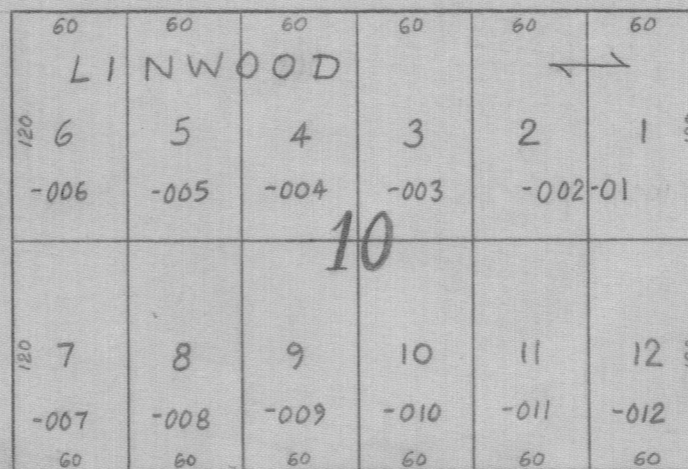

FOURTH

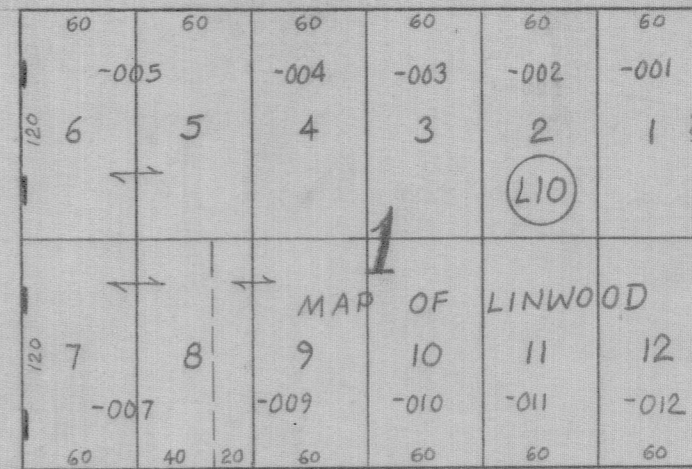

THIRD

CENTER

ST.



1"=100'

SW 1/4 OF SW 1/4 SECTION 35 TIGNRAE